

AquaAmp

INSTALLATION INSTRUCTIONS

400 SERIES WIRELESS CHARGER

PARTS PROVIDED

TOOLS REQUIRED

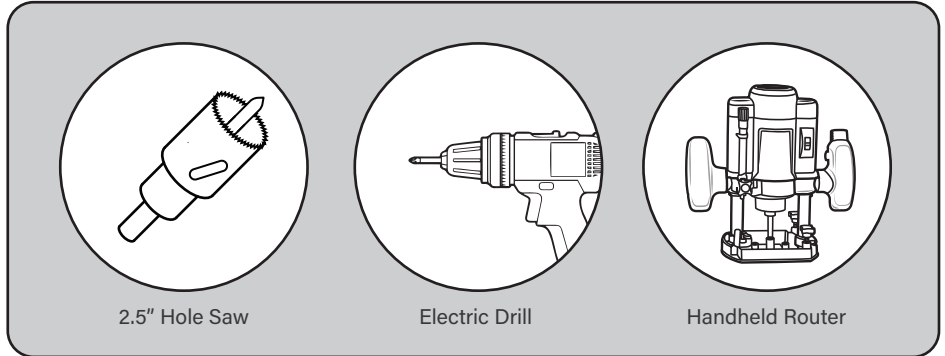
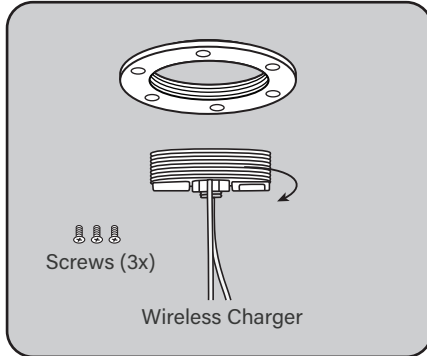

INSTALLATION GUIDE

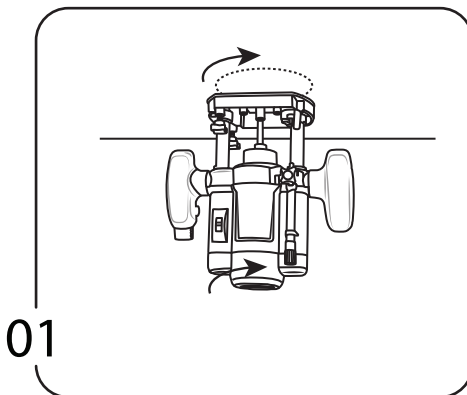

STEP 1: On the underside of the surface, machine a 2.6" diameter recess to a depth leaving < 0.1" of material.

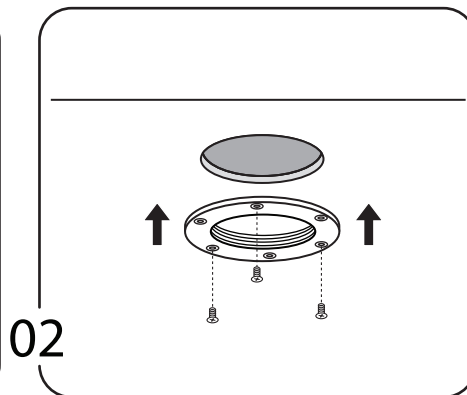

STEP 2: Use the provided self tapping screws to attach the locknut to the underside of the charging surface. Next apply 3M 5200 adhesive to the center of the hole.

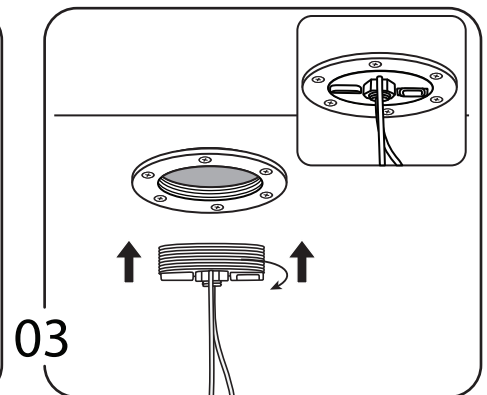

STEP 3: insert the charger into the locknut and turn until it is firmly in place.

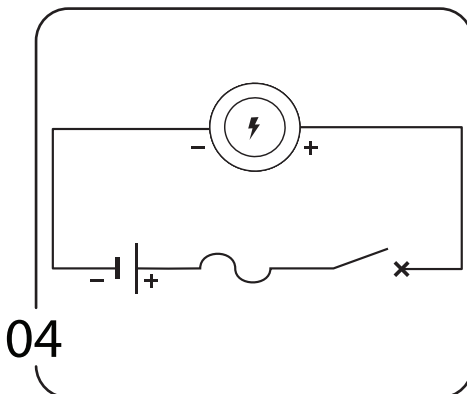

STEP 4: Using a 2A fuse, attach wires to a 12v power supply and ensure there is a waterproof connection.

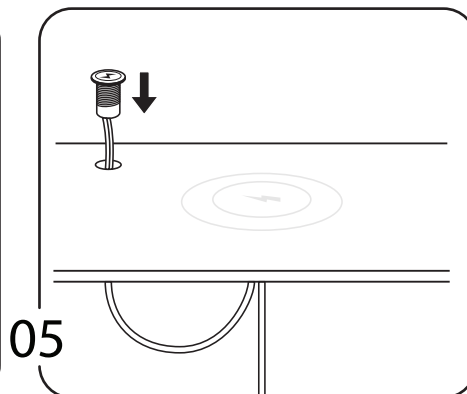

STEP 5 (OPTIONAL): Connect the Digital Output signal to an external system such as a 3.3v status LED.

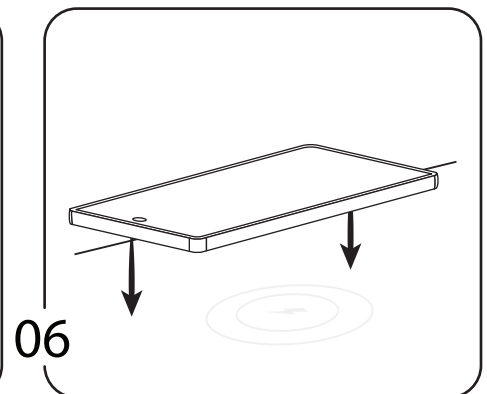

STEP 6: Make sure the charger was installed correctly by placing a wireless charging compatible device in the center of the charger. Check that the device is charging a few seconds after it is placed.

CONTACT:

orders@aquamp.com
13926 Monroes Business Park, Tampa, FL 33635

For further information visit www.aquamp.com