

Parts Provided

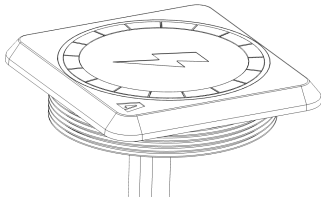

Wireless Charger

Tools Required

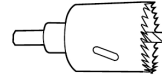

62mm Hole Saw

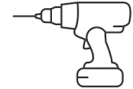

Electric Drill

Installation Guide

Step 1: Drill or Cut 62mm hole.

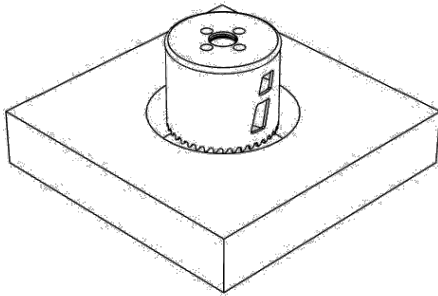

Step 2: Use an alcohol wipe to clean application surface. Remove adhesive backing from the wireless charger and insert the charger into hole.

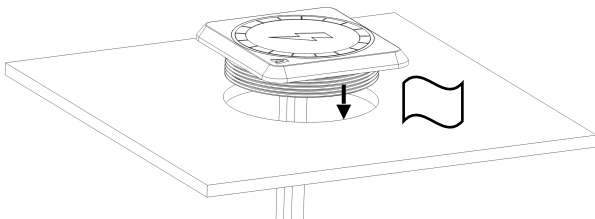

Step 3: Using a 2A fuse, attach wires to a 12v power supply and ensure there is a waterproof connection.

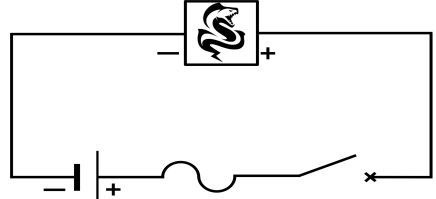

Step 4: Make sure the charger was installed correctly by placing a wireless charging compatible device in the center of the charger. Check that the device is charging a few seconds after it is placed.

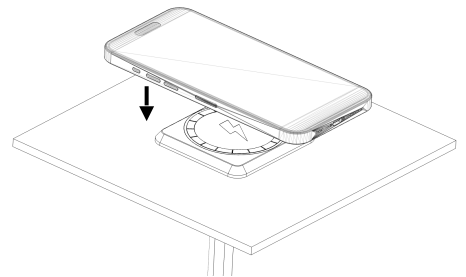

Contact:

orders@aquaamp.com

13926 Monroes Business Park, Tampa, FL 33635

For further information visit www.aquaamp.com